



THE PARISH OF
ST MICHAEL
& ALL ANGELS
BEETHAM

Parish Profile

*We seek to worship God
and show the love of
Christ to all*

beethamstmichaelandallangels.co.uk

Our Vacancy Prayer

*Almighty God,
you have given the Holy Spirit to your Church
to lead us into all truth:
bless with your grace and guidance those who
will seek a new priest for this parish,
that they and we may be steadfast in faith
and united in love;
that we may seek your will,
show forth your glory,
and prepare the way of your kingdom.
Through Jesus Christ, your Son, our Lord.
Amen*



Welcome 03

Our Priest 06

Our Parish 07

Our Church & Worship 09

Our Outreach & Mission 12

Our Buildings & Finances 17

"A privilege and a solace to be able to reflect on this most beautiful God's House"
Church Visitors Book, *Visitors from Bolton-le-Sands*

Welcome from the churchwardens

"Welcome to St Michael & All Angels". These are words we would like to be able to say to you in person quite soon.

If you are reading this, you will know that we are looking for a priest. In our particular case this means a 'House for Duty' priest who will be part of our church and village community here in Beetham. You will find elsewhere in this parish profile information about the church, the village and the local area. So what we want to tell you is that we, as churchwardens, feel privileged to be part of a committed team of people here at St Michael & All Angels who worship, work and play together and in doing so ... have fun (even our PCC meetings are enjoyable!).

As a church we are accessible and welcoming. Our visitors' book is full of comments which reflect our vision of St Michael & All Angels as a place where everyone feels at home. Our work as Churchwardens during this interregnum has been interesting, varied and, at times, challenging, but the support we have from the congregation and the wider community makes the task enjoyable and immensely rewarding.

However, we are not complacent and we want to find someone who can lead, direct and challenge us to continue to develop and grow our vision for the benefit of all. We want to find the person who is willing to use the abundant skills of the existing team and add new dimensions to our growth as a church community.

What can we offer in return? We are a friendly and welcoming congregation. We have hard working and enthusiastic groups of people who lead worship, take the church out into the community, maintain the building and raise money. In short, we do our best to demonstrate our Christian faith in practical ways that benefit as many people as possible. We will give unfailing support to our new priest.

We could talk all day about what makes St Michael & All Angels a special place for us. Mere words, however, can give only the smallest hint of what might make it special for you, too.

Thank you for taking the time and trouble to read this, even if you decide that we are not the challenge you are looking for at this time. We would be happy to try to answer any questions you may have.

Brian, Ian and Jenny



St Michael & All Angels, Beetham



What makes Beetham Parish a special place?

Beetham is a picturesque Cumbrian village in the Arnside & Silverdale Area of Outstanding Natural Beauty with a population of around 600. The Parish lies along the A6 between Lancaster and Kendal, with excellent road and rail links north and south



St Michael & All Angels is our beautiful and well maintained Grade 1 listed historic church which is open to all, every day of the year

Strong links are in place with our village Church of England Primary School, which has been assessed as 'Outstanding' in the 2018 Statutory Inspection of Anglican and Methodist Schools, and 'Good' by Ofsted

The Parsonage is a delightful house set in the heart of the village with lovely views. It is central to the vibrant and friendly community within the village and surrounding areas



"We enjoyed very much looking round your beautiful church and surrounding village. Thank you" Visitors from Manchester

Who makes Beetham Church special?

Congregations at our three services each week: Sunday Parish Eucharist, Sunday Evensong, and Wednesday Holy Communion. Sunday services are supported by robed Worship Leaders, Crucifer, and a robed Choir

Experienced Worship Team of five who regularly take Evensong and are all licensed to administer the chalice; two also have the Bishop's licence to administer the Host

Two dedicated Lay Ministers



Three motivated and faithful Churchwardens

Talented team of professional organists who play for services, weddings, baptisms & funerals



Strong rotas of regular readers, intercessors, and sidespeople

Two Cumbrian Dementia Enablers, who are Alzheimer's dementia champions

Flower arrangers and cleaners who keep the church looking beautiful

Active Tower Bell band who ring for all services and special occasions

The Parochial Church Council is a cohesive team of experienced, enthusiastic and motivated volunteers working together with a common purpose - the wellbeing of the parishioners, the church and the community

Experienced Fabric Committee members manage the maintenance and improvement of the church fabric

Two Kendal Deanery Synod representatives and one Kent Estuary Group representative

The Beetham Church Heritage Trustees administer a registered charity for maintenance of the fabric of the church



The Friends of Beetham Church tirelessly and humorously raise money to support our worship, fabric, and charitable giving

Enthusiastic Handbell Team and emerging Community Music Band providing outreach

Seven Foundation Governors from the church which includes the Chair and Vice Chair of Governors of Beetham School. Enthusiastic and motivated team of church helpers who support staff and pupils in school every week

Team providing in-house production of 'The Gateway' parish magazine which is delivered free monthly to every household in the parish



"Our second visit to this beautiful, peaceful church. Absolutely love all the fresh flowers & polished brass. Someone works very hard here! Looking forward to enjoying a service here!" Visitor from Parbold

How will our Priest inspire us?



We are looking for a House for Duty Priest who is...

- ◇ A motivational preacher, teacher and prayerful leader
- ◇ Warm and friendly with a good sense of humour
- ◇ Pastorally sensitive, ready to listen and empathise appropriately
- ◇ Actively supportive of the work of the school
- ◇ Keen to promote strategies for the development of theological learning and reflection
- ◇ Committed to driving forward plans to reorder the church building
- ◇ Prepared to further the work of the Kent Estuary Group
- ◇ Willing to contribute to the life of the wider community



"There is a real sense of history here. To remember that Christ has been proclaimed here for 1000 years. To Him be the glory" Visitors from Australia

OUR PARISH

Beetham lies on the A6 in Cumbria between Lancaster and Kendal, and the ecclesiastical parish consists of the hamlets of Beetham village, Farleton, Hale, Haverbrack, Sandside, Slackhead and Whassett, bordering the scenic Kent estuary.



The civil parish is larger and lies within the District of South Lakeland and the parliamentary constituency of Westmorland and Lonsdale. There are frequent fast trains from nearby Oxenholme the Lake District station to London Euston. Junction 35 of the M6 can be reached in 10 minutes.

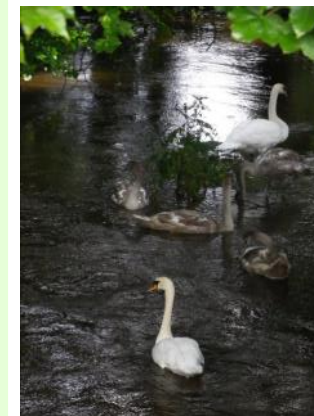

Named after the River Bela, which runs through the village, Beetham is within the Arnside and Silverdale Area of Outstanding Natural Beauty and both the Lake District

National Park and Yorkshire Dales National Park are within 20 minutes drive.

St Michael & All Angels, Beetham

The adult population is around 600, many of whom are retired professional people who have moved into the area. The main sources of employment are a large paper mill and a popular garden centre, together with agriculture and service industries. There are 5 caravan/chalet holiday parks in the parish adding an extra holiday population to the area, some of whom attend church in the Summer months.

Beetham village is a popular tourist destination for walkers, as it is located on the Westmorland Way, and lies on the old coffin route from Arnside over the Fairy Steps.



We have been pleased to welcome groups into the church for guided tours and refreshments, and we are always looking at new ways to attract visitors, such as the NationalChurchesTrust.org/explore-churches website.

A supermarket, local shops and healthcare practices are available in Milnthorpe, and all urban amenities can be found in Lancaster and Kendal - both within 30 minutes travelling by car, and on the local bus route from Beetham and Hale, and the local train from Arnside



BEETHAM C of E SCHOOL

There is a long history of schools in Beetham and the present CE primary school is thriving and attracts pupils from a wide area. This year there are 57 pupils enrolled in KS1, KS2 and Reception, with a further nine children attending the newly opened Nursery School.

The School had an Ofsted inspection in January 2017. The outcome was that **"This school continues to be good"**

Foundation governors of the school are appointed by the Diocesan Board of Education, acting upon the advice it receives from the PCC. All the governors are very active in taking part in school life, through day-to-day volunteering and supporting religious education.

Assemblies are held daily at school and church members are encouraged to attend – in particular at the 'celebrations' assembly each Friday morning where the children are keen to share their enthusiasm for everything they have done during the week.

The headteacher, Wendy Nicholas, is clear that the links between the school and the church have a very positive impact for both



"We like the way that the church and school works together it makes us the best school ever, they should knock down the church and build it closer to the school. The church is about Jesus and religious stuff. We like the services we have in church, we liked the harvest story.

We like doing plays in the church, it's more holy. I relax when I go into church and I'm thankful to god. I love going to church, it's like going home " KS2 pupils at Beetham CE School

organisations. *"Members of the church visit school on a daily basis to provide support for learning, help with clubs and additional activities relating to church seasons. The school visits church regularly for services, as a learning resource and has an extensive display which showcases the children's work and informs the church community about the learning at school."*



"The church and the school fundraise together, learn together, have fun together and worship together. This brings a huge amount of empathy, warmth, friendship and Christian love between all the children and adults involved, building a church and school community of which we are immensely proud."

The latest Diocesan SIAMS inspection in March 2018 rated the School's provision as **"Outstanding"**. The report notes that *"One volunteer remarked that working with the school breathes new life into the church."*

OUR WORSHIP

Our regular pattern of worship is:

- ♦ Parish Communion (Common Worship) with vested clergy, crucifer, servers, robed choir and professional organists, has an average congregation of around 50 on Sunday mornings.
- ♦ Evensong (BCP) is sung with a choir and small congregation of around 13 every Sunday evening.
- ♦ Holy Communion (BCP) is celebrated in the Lady Chapel weekly on Wednesdays and daily in Holy Week.
- ♦ Special services at Easter and Christmas attract many additional visitors - in 2017 there were 114 at Easter Sunday Eucharist, 235 at the Christingle and 122 at our Nine Lessons & Carols.



During 2017 there were 8 baptisms, 4 marriages, and 7 funerals. The PCC supports an open baptismal policy but with adequate preparation, and sensitive and caring follow-up. There are agreed policies to enable baptisms, marriages and funerals for people from outside the Parish who have established a connection with the church,

either by their own worship or through their family. Baptism is encouraged without undue prior commitment but rather is seen as the start of a welcoming process. We are not opposed to the remarriage of divorcees, believing that Christ's example should lead toward repentance, forgiveness and reconciliation.



Every Sunday refreshments are served after the Eucharist

We are a liberal and welcoming church with a very definite emphasis on the Eucharist. The Sacrament is reserved in the aumbry (with the oils) and Holy Communion is taken out to residential nursing homes in the local area, and, by arrangement, to individuals who are unable to come to church because of illness or injury.

Currently, in the absence of a parish priest, this is done by our own licensed lay ministers who also ensure the continuation of our midweek Service of Holy Communion (BCP) in church as Public Worship with Communion by Extension. Five Worship Leaders regularly take Evensong and are licensed to administer the chalice.



MUSIC

Our music and choral traditions are important. The fine organ built by Forster and Andrews of Hull was fully overhauled in 1995 and is regularly tuned and serviced. In recent years highly qualified organists have brought a new dimension to the worship in Beetham; they have reinvigorated the choir, which is dedicated and keen.



A particular highlight of the Church year is the Festival of Nine Lessons and Carols, held on the last Sunday in Advent. An augmented choir and a candlelit church, together with the traditional form of bible readings and Christmas carols, attracts a large congregation of worshippers.

There is an enthusiastic team of bellringers who ring each Sunday and for special occasions. The Church also owns a lovely set of handbells which are regularly played. In 2017 a Community Band was formed to encourage 'mature' musicians of all standards to get together informally and play music each Saturday in church.

CLERGY, LAY MEMBERS & PCC

Among our current Church membership are two retired Priests. Both are licensed to officiate in the Diocese and have been very active during the current vacancy, together with clergy from neighbouring parishes who have generously given their time to help us maintain our full pattern of services.

There are 107 members on our electoral roll. Among the lay members of the parish is a wealth of talent, professional skills and generosity of spirit: many tasks are carried out routinely and reliably that might otherwise result in significant expense. There are three churchwardens, elected annually, and two lay



representatives on Kendal Deanery Synod.

The PCC meets every two months. In addition to the ex-officio members there are 9 directly elected members,

each serving for 3 years. Between meetings matters are dealt with by Standing Committee (Incumbent, Churchwardens, Secretary, and Treasurer). The PCC does much of its day-to-day detailed business through its Fabric and Finance sub-Committees. These consist of enthusiastic PCC representatives and co-optees with particular skills in these areas.

Lay leadership is mature and strong and most Church members undertake one or more duties on a regular basis, whether sidespeople, intercessors, cleaners, flower arrangers or many more roles whenever they are needed.

"What a lovely church, I really enjoyed listening to the choir"

Visitors from Arnside

DIOCESE, DEANERY & KENT ESTUARY GROUP



Beetham parish lies along the southern boundary of Carlisle Diocese within the Archdeaconry of Westmorland and Furness. There are regular links with the Diocese for worship, church and CE school administration.

The Diocese of Carlisle has an ongoing initiative, God for All, which aims to give everyone living in Cumbria the opportunity to



experience the joys and benefits of Christianity. As part of that initiative, a special event this year entitled, appropriately, Moving Mountains, has encouraged

Mission Communities to organise events to take the message of Christ's love out into their local area. Members of St Michael & All Angels were actively involved in the Kent Estuary Group's themed weekend of events, 'Who is my Neighbour?' A 'Big Soup' event in Arnside and Dementia friendly sessions in Milnthorpe attracted large numbers of people who were able to share their understanding and experience of Christian awareness and what it can offer.

Clergy from around the country were invited to come and help to 'Move Mountains' and we were delighted to welcome to our Church the Rev'd Helen Burn from Rochester who came to preach at our Eucharist Service on

Mothering Sunday. On her return home, Helen sent us a message of thanks for the warm welcome she had received here in Beetham.

We are committed to the Deanery Strategy of parishes working together.

The Kent Estuary Group comprises the parishes of Arnside, Beetham, Levens, Heversham, and Milnthorpe, and Beetham has an elected lay council delegate. The constitution of the Group echoes the PCC's strongly held commitment to retain our legal entity, our own PCC and control over our parish finances.

There are no other places of worship in Beetham parish. Methodist and Roman Catholic members worship in Arnside and Milnthorpe, and the Society of Friends in Yealand Conyers or Preston Patrick, but some join us in Beetham and all are made welcome and invited to participate in the Eucharist, and we fully support the work of the Kent Estuary Group to ensure that, between us, we are accessible to all.

Our vision, and where we are looking for the leadership and guidance of a new priest, is to see our church and the community it serves grow in the knowledge of God's love and continue the work of Moving Mountains. As a relative newcomer to our community recently said, *"It's not just about moving mountains but of digging tunnels into them"*.



OUR OUTREACH



St Michael & All Angels is an integral part of the community in Beetham. Even among those residents who do not attend church services regularly there is a strong feeling, often expressed, that this is 'our church'.

Established as the fundraising arm of the Beetham Church Heritage Trust, the 'Friends of Beetham Church' are at the centre of the social life of the Parish and are the means by which much of the outreach work of the Church is achieved. The Friends organise activities that are community based and which take place throughout the year.

The Annual Duck Race on the River Bela has become a popular event which attracts people from a wide area to come to the village. Our Annual Flower Festival, usually based on a theme - this year celebrating the 100th anniversary of the foundation of the Beetham WI - attracts hundreds of visitors and draws much praise for the quality of the exhibits.

- ◇ Shrove Tuesday and Harvest are celebrated with social events which bring people together in a common purpose to share in good fellowship (and good food and drink!)



- ◇ Every month, our Parish Magazine spreads news of what is happening in church to the wider community.
- ◇ We have a presence every year on Beetham Sports Day, continuing a tradition which is 100 years old.
- ◇ Our Handbell Team goes out to entertain residents in local nursing homes, and at other local venues.



"What a wonderful visit. Walked into the church and immediately got 'roped in' to join the hand bell ringers - wonderful!" Visitors from Thornton Dale

- ◇ A monthly coffee morning in church attracts visitors from far and wide.
- ◇ Carols Singers collect around Slackhead and 'Beetham Bottoms' every year for a nominated charity. Concerts, a Winter Fair, an annual Plant Stall at Dallam Tower, 'Drop-in' Lent lunches, all contribute to our mission.



This is not an exhaustive list, but shows, we think, that as a church, we reach out to let people know we are here. One measure of our success this year must surely be that we have five people (three adults and two young people) being prepared for Confirmation in May.

We have two Dementia Champions who are also Dementia Enablers for Cumbria. Through their good offices, all members of the PCC have received Dementia Training and raising Dementia Awareness is included in our Mission Action Plan.

St Michael & All Angels, Beetham



In short, we are an active church which sets out to demonstrate the love of Christ in practical ways seeking to benefit both individual parishioners and the whole community. We give real help to those in need and offer emotional and spiritual support through our pastoral work.

That we have been able to continue this work to maintain the visible presence of St Michael & All Angels in the absence of our own vicar is a tribute to the committed team we have here. To have once again a 'Priest in the Parsonage' would help us to build on these strong foundations and to take God's message to a wider and wider audience.



MISSION ACTION PLAN

Our Mission Action Plan has been updated and refreshed in an exercise that began last year, the previous four year plan having run its course and been successfully implemented, with objectives achieved either completely or in part.



A remarkable degree of unanimity during the consultation exercise reflects the concerns that have come to the fore in recent years and has enabled us to incorporate all the main opinions expressed in

The updated plan has been adopted by the PCC and will run until 2022. It has been compiled following a consultation exercise with the whole congregation who were given an 'open-ended' opportunity to say what they thought to be important for St Michael & All Angels, and the actions are a genuine reflection of the wants and needs of the congregation.

Like all churches, we are faced with the challenges of maintaining (or growing)

the revised MAP. Key areas for attention are outlined here, and the detailed plan is available on our website.

Firstly, and significantly, all respondents expressed the wish that we work to maintain what is variously described as the traditional style of worship that attracted them to St Michael & All Angels in the first place. This includes such things as robed clergy, our tradition of church music, with an organist, a robed choir, hymns and sung responses.



numbers in our congregation, of attracting younger people, of maintaining the fabric and structure of our church building. These challenges are always a part of our planning process. However, we believe that our MAP must also include short-term achievable and measurable objectives and it is with this in mind that our new plan has been drawn up.



"Nice Evensong. We will come again next time we are in the area"
Visitors from Frodsham

Secondly, an overwhelming majority of respondents want to see a re-ordering of the interior of the church building to make it a more flexible space for wider community use. This wider use includes activities which will form part of our 'Mission' and our 'Outreach', as well as regular activities such as school assemblies and the annual Nativity Play.



Our Fabric Committee has been investigating possibilities and last year held an open meeting inviting all interested parties to say what they would like to see (and, indeed, not see) done to achieve this end. As a result, the PCC agreed an initial expenditure to investigate the possibilities and a meeting has been arranged with our Architect to consider, as a first step, a limited project to provide a more comfortable (and safer) area at the rear of the church where we gather every week after morning service for coffee.

A major new area in the current plan is for us to develop a role as a Dementia Friendly church. This reflects our growing awareness of Dementia in its varied forms as an area where we can make a significant contribution in raising the profile of the need for care and treatment of people living with Dementia and, just as importantly, in providing support for those who care for them. The PCC regards this as a vital and important aspect of our updated MAP.

This Parish Profile is part of our response to the expressed wishes of the congregation and overall, we intend to do our best to combine continuing support for our traditions with a determination to continue to grow as a 'Mission Community'.



BEETHAM COMMUNITY



The church is very much at the centre of Beetham village - geographically, socially and spiritually - and there are strong links with Beetham C of E Primary School, the Wheatsheaf Hotel, the Old Post Office Tea Room & Shop, the W.I., Beetham Nurseries, Beetham Sports, and the Heron Theatre.



In addition to the church there are a number of listed buildings; Beetham Hall, pictured below, is mentioned in the Domesday Book and is now the local Crematorium; the Heron Corn Mill was established in C13th, and the original paper mill in C14th.



Our Parish magazine 'The Gateway' is produced in-house each month and is delivered free to every household and local businesses. As well as church items it includes local news and a guide to events happening in the area, and is a popular source of information for the community and visitors. It is included on our website, www.beethamstmichaelandallangels.co.uk



"Loved getting here after the Fairy Steps. I really like the children's corner"
Visitors from the Cotswolds

OUR CHURCH BUILDING

The parish church of Beetham was founded in Saxon times and may have been dedicated to St Lioba, a cousin of St Boniface. The dedication was later changed to that of St Michael and All Angels. The chancel was extended in the thirteenth century, the Chapel added in the fourteenth century, and the north aisle added and south aisle widened in the fifteenth century. A tomb dating from c.1490 separates the chapel and choir, which was severely damaged in 1647 by soldiers of Fairfax. The top stage of the tower was added in the sixteenth century. It is now a Grade I listed building.



One of the most fascinating sources of information on the early development of our Church and parish heritage was collected and transcribed by the Reverend William Hutton, Vicar of Beetham from 1762 to 1811, and published as the 'Beetham Repository'.

PLAN of St. MICHAEL and ALL ANGELS

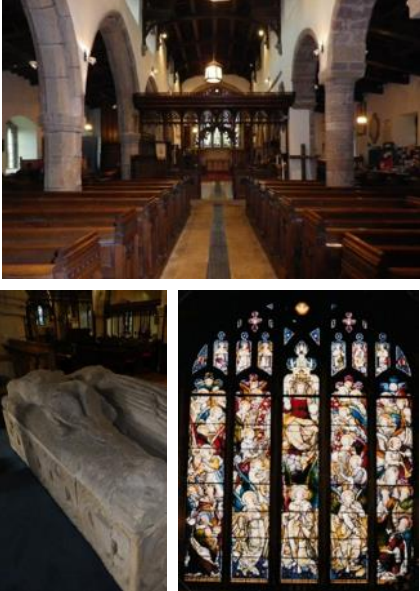
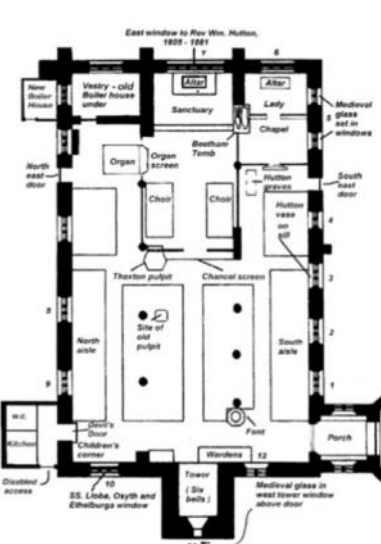

The stained glass windows and memorials provide an interesting history of the area, commemorating a number of noted local people. Fragments of medieval glass survived the 1647 damage in the Chapel, and the west window in the Tower also contains medieval glass of a similar period. Victorian woodwork adds a significant impact to the interior, and various masons marks are found on the older stonework.

Our unique Nativity scene was carved by German prisoners of war at the Bela camp, and donated to the church at Christmas 1946 'to express gratitude for the real spirit of Christian brotherhood experienced at Beetham'. Each piece is hand-carved and



and is still in regular use and remains in good condition to the present day.



OUR PARSONAGE



The downstairs accommodation comprises a large sitting room, dining room, study, good sized fitted kitchen with walk-in larder, and cloakroom with WC.

The Parsonage is located in a central position in the village, close to the church, with views from the front across open fields. The house is constructed in traditional local limestone typical of the older part of the village.

The 1830's property has retained many period features, including leaded light windows, some Georgian style windows with shutters, a wood block floor in the impressive entrance hall, and archways in the hall and on the landing.

The property has a garage, and a lawned garden with borders and a selection of mature trees to the rear. In winter time there are lovely views from the garden to the north east towards Farleton Knott.



An oak staircase leads to the first floor landing, with four double bedrooms, and another study. There is a bathroom and separate shower room.

The Parsonage is connected to all mains services and broadband, and benefits from gas central heating. It has been well-maintained and decorated throughout.

It is managed by The Diocesan Parsonages Board on a systematic basis with a clearly established division of responsibilities between the Board and the occupiers.



"Thank you for a very meaningful service and for your generous welcome" Visitors from Norfolk

FINANCES

In recent years the Diocese has introduced a Parish Offering system, asking Parishes to make offers that at least cover the cost of ministry in each Parish. We have managed to meet this challenge, with a small additional offering each year. The PCC also meets the ministerial expenses of our house -for-duty priest.

The level of giving, with much use of Gift Aid, is closely monitored by the Finance Committee and the PCC. Although it is now some years since the last formal stewardship campaign, the PCC has from time to time initiated a reminder exercise, pointing out that inflation may have eroded the buying power of our regular giving: this has been responded to with conscientiousness and good heart. A possible Stewardship Campaign is included in our new Mission Action Plan.

Thanks to careful monitoring of expenditure, our reserves have been rebuilt since they were somewhat depleted by the cost of electrical works some years ago. Our annual balance sheet currently shows a healthy surplus of receipts over payments and our reserves, as shown in our 2017 Accounts,

indicate a strong position from which to tackle any work highlighted in this year's Quinquennial Inspection.

The PCC has established a Missions Sub-committee and aims to donate around 10% of its income from collections and direct giving. This includes our ongoing



support of a range of church missions and charities, local charities such as Manna House and Springfield Hostel in Kendal, the Children's Society Christingle Appeal, Crisis at Christmas and Christian Aid Week.

Individual events, such as our Lent Drop-in Lunches and our Christmas Carol Singing around the village are organised with the aim of collecting for specific charities nominated by the PCC.

When fundraising is required, we try whenever possible to do so in an entertaining way – it is fair to say that both fun and funds are the result!



A full copy of the 2017 audited Annual Accounts can be found on our website

St Michael & All Angels, Beetham



"I have been absent from church for more years than I can remember. Nothing seemed to ring true to me. Church is as much about the people as it is about the religious text.

When we moved to Beetham I have to say the outreach from the congregation, on every level, has slowly begun to make me look to the church once again.

As with so much in life the proof of the pudding is not truly known until one begins to "eat" it . Here at St Michael and All Angels, there is a most unique recipe that is shared happily with all"

Tess Rowlands, Beetham PCC member

**Thank you for reading our Parish Profile and we hope that we have inspired you to join us.
For more information please visit our website at www.beethamstmichaelandallangels.co.uk**

"A thousand years old. Cool"
Young visitor from Stockport

